



IP67

# MOFS03

## STAINLESS STEEL FLOODLIGHT FOR HST/HSI E40 LAMP

### APPLICATION AREA:

Multipurpose floodlights for engine rooms, weather-exposed areas, cargo holds, decks, stores, workshops, industrial areas.

### DESIGN:

According to the rules of international classification societies, VDE and IEC.

### HOUSING:

Stainless steel, powder coated white RAL 9016.  
Diffuser made of safety glass.  
Reflector made of anodized aluminum, wide beam angle.

### MOUNTING:

Stainless steel bracket with three holes  $\text{r}12$ .

### CONNECTION:

3 pole terminal 6mm,  
Junction box(optional).

### ELECTRIC:

230 V 50 or 60 Hz.  
Flexible cable, heat resistant.

### LAMPS:

E40 max 400W.

### CABLE ENTRY:

Brass cable gland M20.

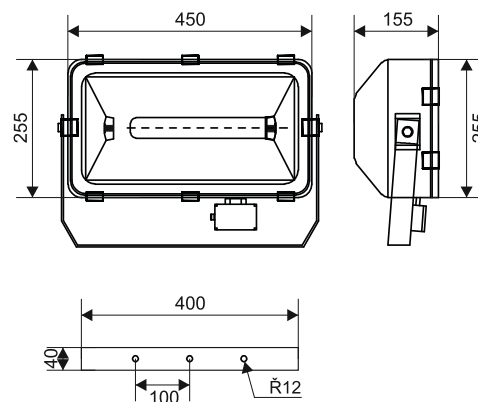

### ORDER CODES:

CODE	VOLTAGE	FREQUENCY	POWER	LAMP
MOFS3-E40	PLEASE SEE THE BALLAST UNIT TABLE			E40

### BALAST UNIT FOR HST/HSI E40 LAMPS:

CODE	VOLTAGE	FREQUENCY	WEIGHT
MOFS3 BU-250-11	230V	50Hz	11.5 Kg
MOFS3 BU-250-12	230V	60Hz	11.5 Kg
MOFS3 BU-250-14	110V	60Hz	11.5 Kg
MOFS3 BU-400-11	230V	50Hz	12 Kg
MOFS3 BU-400-12	230V	60Hz	12 Kg
MOFS3 BU-400-14	110V	60Hz	12 Kg