

# MOFS04

IP67

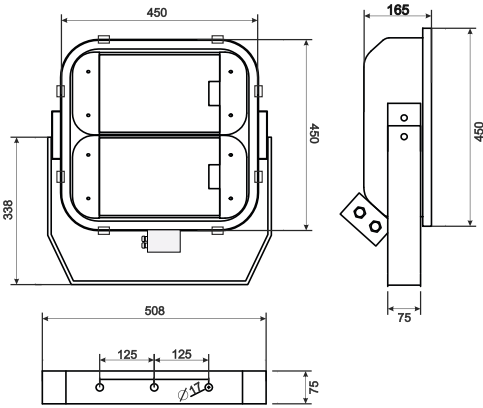

## STAINLESS STEEL FLOODLIGHT FOR HST/HSI E40 LAMP



### APPLICATION AREA:

Multipurpose floodlights for engine rooms, weather-exposed areas, cargo holds, decks, stores, workshops, industrial areas.

### DESIGN:

According to the rules of international classification societies, VDE and IEC.

### HOUSING:

Stainless steel, powder coated white RAL 9016.  
Diffuser made of safety glass.  
Reflector made of anodized aluminum, wide beam angle.

### MOUNTING:

Stainless steel bracket with three holes  $\varnothing 17$ .

### CONNECTION:

Junction box with 6mm<sup>2</sup> terminal and ignitors.

### ELECTRIC:

230 V 50 or 60 Hz.  
Flexible cable, heat resistant.

### LAMPS:

HST/HSI-E40.

### CABLE ENTRY:

Brass cable gland M25.

### ORDER CODES:

| CODE       | VOLTAGE                           | FREQUENCY | POWER | LAMP  |
|------------|-----------------------------------|-----------|-------|-------|
| MOFS4-2E40 | PLEASE SEE THE BALLAST UNIT TABLE |           |       | 2xE40 |

### BALAST UNIT FOR HST/HSI E40 LAMPS:

| CODE            | VOLTAGE | FREQUENCY | WEIGHT |
|-----------------|---------|-----------|--------|
| MOFS4 BU-250-21 | 230V    | 50Hz      | 19 Kg  |
| MOFS4 BU-250-22 | 230V    | 60Hz      | 19 Kg  |
| MOFS4 BU-250-24 | 110V    | 60Hz      | 19 Kg  |
| MOFS4 BU-400-21 | 230V    | 50Hz      | 20 Kg  |
| MOFS4 BU-400-22 | 230V    | 60Hz      | 20 Kg  |
| MOFS4 BU-400-24 | 110V    | 60Hz      | 20 Kg  |

MARINE LUMINAIRES